

FEATURED ALUM-A-LIFT

WIDE SPAN ADJUSTABLE NOTCHED FORK SET LIFT

PROJECT 33589

MODEL A800CS-72

FEATURING Wide Span, Adjustable Notched Fork Set Lift, Rigid Front Casters, Non-Marring Cradle

HANDLING 300 lb [136 kg] Rolls

DETAILS Users of coating machines often need to transport large rolls of valuable product to a staging area while avoiding direct contact with the material. This Alum-a-Lift features a wide span, width adjustable fork set to safely handle large roll to roll production coaters. Non-marring cradles protect the shaft from damage. Rigid front casters allow for the operator to easily transport material over a long distance.

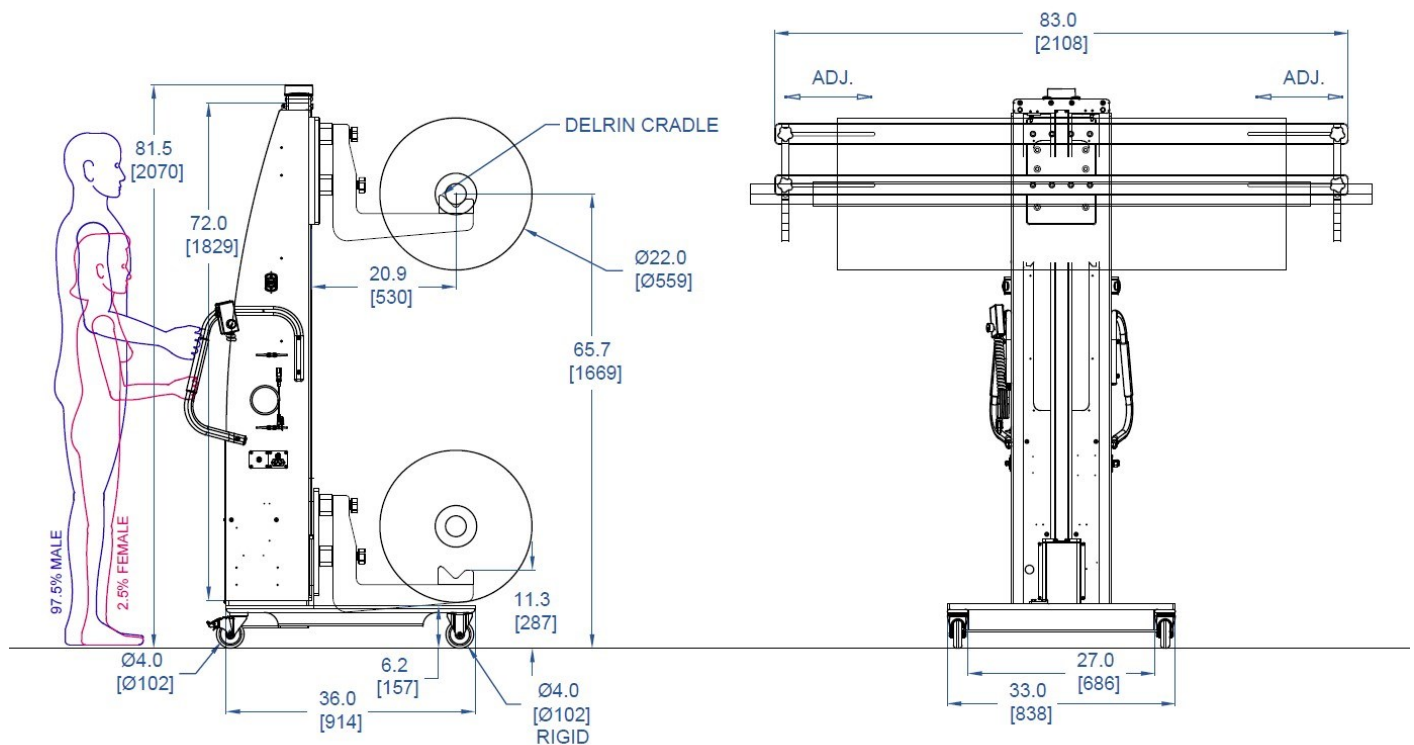

alum-a-lift

13941 Veterans Memorial Hwy
Winston, GA 30187 USA
+1 770 489 0328

GET STARTED AT ALUM-A-LIFT.COM